

EQUIPMENT



STATIC SCREEN

STATIC SCREEN

- **No Power Pequired:** Passive operation reduces OPEX and improves reliability.
- **High Capture Efficiency:** Wedge wire profile screen intercepts suspended solids and fibres.
- **Low Maintenance:** Smooth slots resist clogging; easy washdown and access.
- **All Stainless Construction:** Corrosion resistant structure with long service life (SS304/SS316 optional).
- **Compact Footprint:** Inclined arc screen provides high throughput in a small space.



Working Principle

The static screen uses a stainless-steel arc-shaped screen made of wedge-shaped bars. Wastewater is evenly distributed over the inclined screen surface via an overflow weir.

Because the screen has narrow, smooth gaps on the front and wider, smooth drainage paths on the back, solids are intercepted on the front while the filtered water flows through the gaps.

Under hydraulic pressure, captured solids slide downward along the screen to the lower end for automatic discharge, achieving solid-liquid separation.

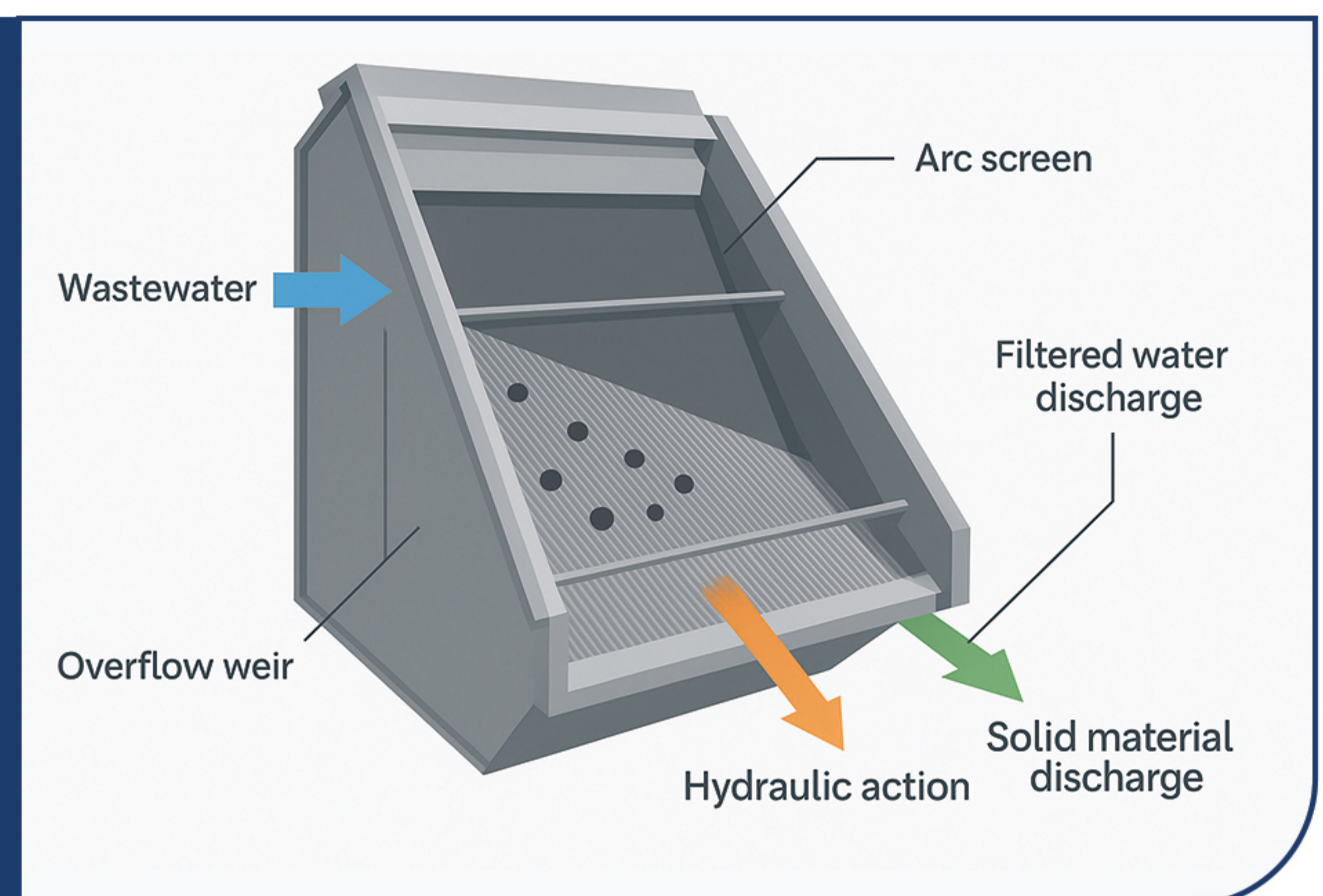

Features

Standard Features

- Inclined wedge wire arc screen assembly with profile wire slots.
- Overflow distribution weir for uniform loading.
- Stainless steel frame and guards (SS304 standard; SS316 available).
- Open channel or tank top mounting with solids chute and filtrate outlet.
- Easy cleaning via hose down; minimal moving parts.

Options & Accessories

- Material upgrade to SS316 or duplex (on request).
- Slot sizes (typ.): 0.5 / 1.0 / 1.5 mm.
- Custom inlet weir, covers, spray wash header, splash guards.
- Support stands, drain pan, flanged outlets, instrumentation ports.
- Integration with upstream coarse screens or downstream

Specifications and Parameters

Model	Capacity (m ² /hr)	Capacity (m ² /hr)	Capacity (m ² /hr)	L (mm)	W (mm)	H (mm)
Mesh	1.5 mm	1.0 mm	0.5 mm	-	-	-
HS-300	~16	~13	~6	1420	430	1900
HS-500	~35	~22	~10	1420	630	1900
HS-600	~42	~27	~12	1420	730	1900
HS-700	~48	~31	~15	1420	830	1900
HS-800	~55	~35	~17	1420	930	1900
HS-900	~62	~40	~19	1420	1030	1900
HS-1000	~70	~45	~22	1420	1130	1900
HS-1200	~77	~52	~26	1420	1330	1900
HS-1500	~100	~65	~32	1420	1630	1900
HS-1800	~120	~80	~40	1420	1930	1900

WASTEWATER, CLEAN-GAS & ENVIRONMENTAL SOLUTIONS



 +61 (2) 40923110

 5 Moorak St
Taringa QLD 4068
Australia

 AQUIPTEC.COM.AU

 INFO@AQUIPTEC.COM.AU